

ÄNDERUNG DES BEBAUUNGSPLANES "AM STEINBERGWEG" IN DEMLING Blatt 2  
 FÜR DIE GRUNDSTÜCKE FL.NR. 292/1-5, 292/7-15 u. 290 - 290/5

Zustimmung der betroffenen Grundstückseigentümer

- |              |                           |              |                                   |
|--------------|---------------------------|--------------|-----------------------------------|
| Fl.Nr. 290   | <i>Endisch</i><br>Endisch | Fl.Nr. 290/3 | <i>Kürzinger Bl.</i><br>Kürzinger |
| Fl.Nr. 290/1 | <i>Blab</i><br>Blab       | Fl.Nr. 290/4 | <i>Frank</i><br>Frank             |
| Fl.Nr. 290/2 | <i>Biegerl</i><br>Biegerl | Fl.Nr. 290/5 | <i>Sangl</i><br>Sangel            |

JETZIGER ZUSTAND

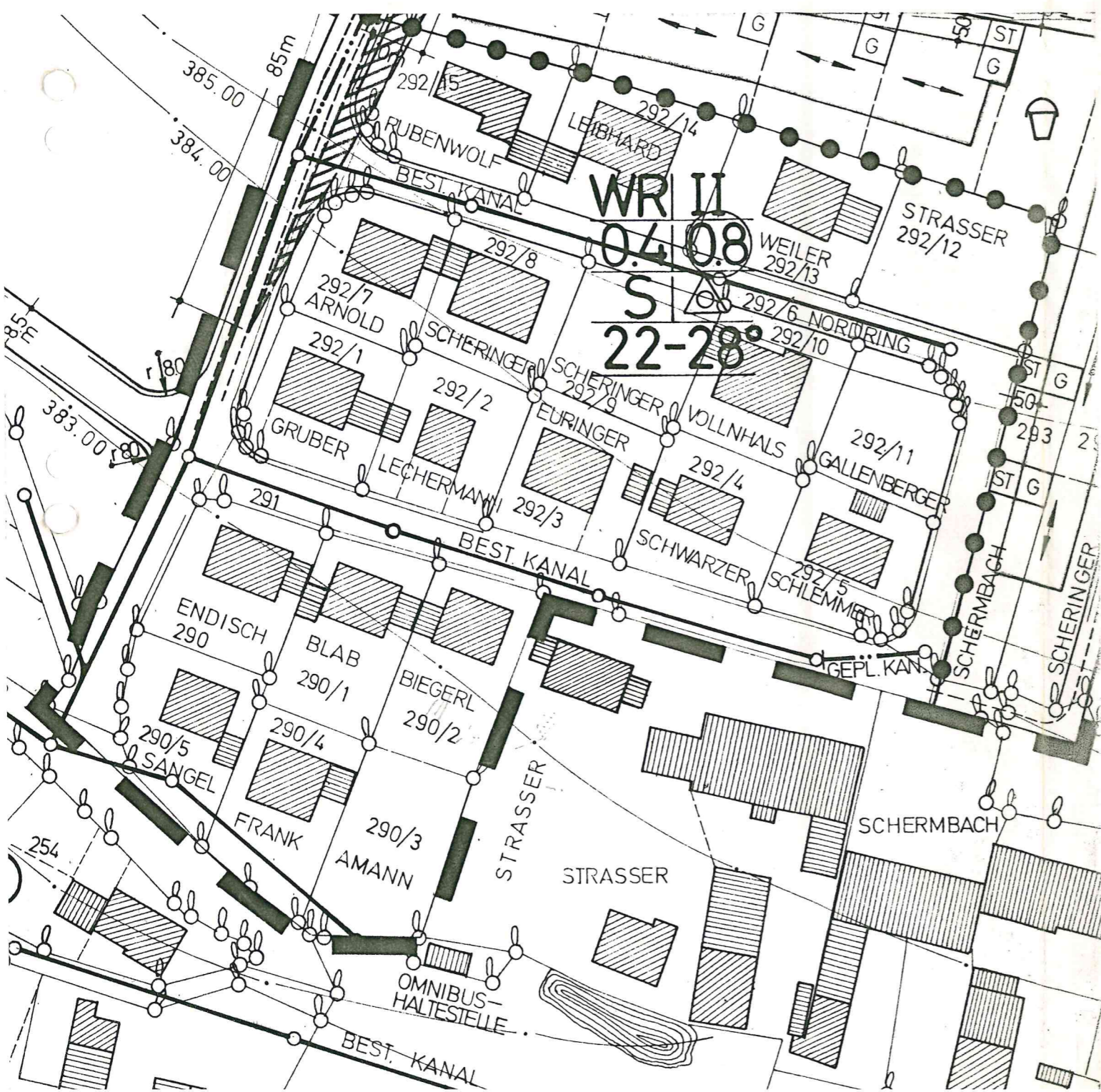

- |              |                                 |               |                                     |               |  |
|--------------|---------------------------------|---------------|-------------------------------------|---------------|--|
| Fl.Nr. 292/1 | <i>Gruber</i><br>Gruber         | Fl.Nr. 292/8  | <i>Scheringer</i><br>Scheringer     | Fl.Nr. 292/14 | <i>H. Leibhard</i><br>Leibhard         |
| Fl.Nr. 292/2 | <i>Lechermann</i><br>Lechermann | Fl.Nr. 292/9  | <i>Scheringer</i><br>Scheringer     | Fl.Nr. 292/15 |  |
| Fl.Nr. 292/3 | <i>Euringer</i><br>Euringer     | Fl.Nr. 292/10 | <i>Vollnhals</i><br>Vollnhals       |               |  |
| Fl.Nr. 292/4 | <i>Schwarzer</i><br>Schwarzer   | Fl.Nr. 292/11 | <i>Gallenberger</i><br>Gallenberger |               | <i>Brigitte Rubenwolf</i><br>Rubenwolf |
| Fl.Nr. 292/5 | <i>Schlemmer</i><br>Schlemmer   | Fl.Nr. 292/12 | <i>Strasser</i><br>Strasser         |               |  |
| Fl.Nr. 292/7 | <i>Arnold</i><br>Arnold         | Fl.Nr. 292/13 | <i>Weiler</i><br>Weiler             |               |  |

Blatt 2

KÜNFTIGER ZUSTAND

